

51030DA08903

City of Cannon Beach
Finance DepartmentCity of Cannon Beach
Finance Department

JAN 30 2023

JAN 30 2023

Tree Removal Application

PAID

Received

Please fill out this form completely. Please type or print.

Applicant Name:

Sophie Avila

Mailing Address:

9310 112th Av NE Kirkland WA 98033 Phone:
617 777 2144 Email: Sophie-leroy@hotmail.com

Property Owner Name:

Sophie Avila Mailing

Address:

131 Hills Ln Cannon Beach OR 97110 Phone:
617 777 2144 Email: Sophie-leroy@hotmail.com

Property Location: Map/Tax Lot Number:

The city shall issue a tree removal permit if one of the following criteria is met. Please circle the letter of the criteria that applies.

These criteria require a Tree Removal Report from an International Society of Arboriculture (ISA) Certified Arborist:

1. You are constructing a structure or development approved and allowed by pursuant to **Cannon Beach Municipal Code 17.70.030**, which involves any form of ground disturbance; including required vehicular and utility access. **SEE ATTACHMENT A - Removing Trees Because of Construction.**
2. Removal of a tree for the health and vigor of surrounding trees.

These criteria require an ISA Tree Hazard Evaluation Form prepared by an ISA Certified Arborist: C. The tree presents a safety hazard, where:

1. The condition or location of the tree presents either a foreseeable danger to public safety, or a foreseeable danger of property damage to an existing structure; and,
2. Such hazard or danger cannot reasonably be alleviated by pruning or treatment of the tree.

D. The tree was damaged by storm, fire or other injury, which cannot be saved by pruning.

You must submit a tree removal permit with a reason if:

E. The tree is dead.

F. Tree removal is necessary to provide solar access to a solar energy system where pruning will not provide adequate solar access:

1. The city may require documentation that a device qualifies for Oregon Department of Energy

Solar Tax Credit, or other incentive for installation of solar devices offered by a utility.

2. No tree measuring more than 24 inches in diameter shall be removed for solar access.

G. Tree removal is for landscaping purposes, subject to the following conditions:

1. The tree cannot exceed 10 inches in diameter.

2. A landscape plan for the affected area must be submitted and approved by the City. 3. The landscape plan must incorporate replacement trees for the trees removed. The

replacement trees must be at least six feet in height or have a two-inch caliper; and ,

4. The City shall inspect the property one year after the approval of the permit to insure the

landscape plan has been implemented.

If your tree presents an immediate danger of collapse and if such potential collapse represents a clear and present hazard to persons or property, **please contact the Community Development Director (CDD)**. If it is determined by the CDD that there is an immediate danger, then a tree removal permit is not required prior to tree removal. However, within seven days after the tree removal, the tree owner shall make application for an after-the-fact permit. Where a tree presents an immediate danger of collapse, a complete ISA Tree Hazard Evaluation Form prepared by a certified arborist is not required. Where a safety hazard exists, as defined by this subsection, the city may require the tree's removal. If the tree has not been removed after forty-eight hours, the city may remove the tree and charge the costs to the owner.

Attach a site plan showing the location and type of all trees on the property, including the trees to be removed. Indicate the location of replacement trees and the type. SEE ATTACHMENT B – Site Plan. Attach photos of the trees to be removed and mark the trees with ribbon.

Explain how the request meets one or more of the applicable criteria. Include the number and type of trees requested for removal. If appropriate, explain why pruning would not accomplish the same goal as tree removal.

Application fee: \$50.00 for 1-4 trees; \$100 for 5 or more trees

Note: The application fee is a **nonrefundable** fee that is due upon receipt of application, whether the removal request is approved or denied.

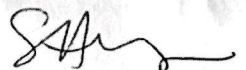
Applicant Signature Date:  11/29/2022

If the applicant is other than the owner, the owner hereby grants permission for the applicant to act in their behalf.

Property Owner Signature: Date:

Please attach the name, address, phone number and signature of any additional property owners.

City of Cannon Beach
Finance Department

JAN 30 2023

PAID

2. No tree measuring more than 24 inches in diameter shall be removed for solar access.

G. Tree removal is for landscaping purposes, subject to the following conditions:

1. The tree cannot exceed 10 inches in diameter.
2. A landscape plan for the affected area must be submitted and approved by the City.
3. The landscape plan must incorporate replacement trees for the trees removed. The

replacement trees must be at least six feet in height or have a two-inch caliper; and ,

4. The City shall inspect the property one year after the approval of the permit to insure the

landscape plan has been implemented.

If your tree presents an immediate danger of collapse and if such potential collapse represents a clear and present hazard to persons or property, **please contact the Community Development Director (CDD)**. If it is determined by the CDD that there is an immediate danger, then a tree removal permit is not required prior to tree removal. However, within seven days after the tree removal, the tree owner shall make application for an after-the-fact permit. Where a tree presents an immediate danger of collapse, a complete ISA Tree Hazard Evaluation Form prepared by a certified arborist is not required. Where a safety hazard exists, as defined by this subsection, the city may require the tree's removal. If the tree has not been removed after forty-eight hours, the city may remove the tree and charge the costs to the owner.

Attach a site plan showing the location and type of all trees on the property, including the trees to be removed. Indicate the location of replacement trees and the type. SEE ATTACHMENT B – Site Plan. Attach photos of the trees to be removed and mark the trees with ribbon.

Explain how the request meets one or more of the applicable criteria. Include the number and type of trees requested for removal. If appropriate, explain why pruning would not accomplish the same goal as tree removal.

Application fee: \$50.00 for 1-4 trees; \$100 for 5 or more trees

Note: The application fee is a **nonrefundable** fee that is due upon receipt of application, whether the removal request is approved or denied.

Applicant Signature Date:



11/29/2022

If the applicant is other than the owner, the owner hereby grants permission for the applicant to act in their behalf.

Property Owner Signature: Date:

Please attach the name, address, phone number and signature of any additional property owners.

Attach a site plan showing the location and type of all trees on the property, including the trees to be removed. Indicate the location of replacement trees and the type. SEE ATTACHMENT B – Site Plan. Attach photos of the trees to be removed and mark the trees with ribbon.

Explain how the request meets one or more of the applicable criteria. Include the number and type of trees requested for removal. If appropriate, explain why pruning would not accomplish the same goal as tree removal.

.....

Application fee: \$50.00 for 1-4 trees; \$100 for 5 or more trees

Note: The application fee is a **nonrefundable** fee that is due upon receipt of application, whether the removal request is approved or denied.

Applicant Signature _____ Date: _____

If the applicant is other than the owner, the owner hereby grants permission for the applicant to act in their behalf.

Property Owner Signature: _____ Date: _____

Please attach the name, address, phone number and signature of any additional property owners.

I understand, as property owner, that I am responsible if an approved tree removal permit is violated in any way. As property owner, my signature or an authorized applicant's signature, allows any duly authorized employee of the City to enter upon all properties affected by this permit, for the purpose of follow-up inspection, observation or measurement.

Date: _____ Fee Paid: \$ _____ Receipt Number: _____ Permit #: _____

Application is:

_____ Approved _____ Denied

 X Approved - Tree replacement required per Cannon Beach Municipal Code 17.70.040, Tree Replacement Policy.

_____ Approved with comments:

By:  _____ Robert St. Clair
Planner Date: February 13, 2023

Decisions on the issuance of a tree removal permit may be appealed to the Planning Commission in accordance with Section 17.88.140 a, of the Municipal Code.



A Photographic Guide to the Evaluation of Hazard Trees in Urban Areas

TREE HAZARD EVALUATION FORM 2nd Edition

Site/Address: 131 HILLS LANE CANNON BEACH
 Map/Location: _____
 Owner: public _____ private ☒ unknown _____ other _____
 Date: 11-2-22 Arborist: BALDEN ISA#: P20736
 Arborist's Signature: [Signature]

HAZARD RATING:

$\frac{2}{\text{Failure Potential}} + \frac{3}{\text{Size of part}} + \frac{3}{\text{Target Rating}} = \frac{8}{\text{Hazard Rating}}$
☒ Immediate action needed
☐ Needs further inspection
☐ Dead tree

TREE CHARACTERISTICS

Tree #: 1 Species: PICEA SITCHENSIS
 DBH: 28 # of trunks: 1 Height: 110 Spread: 20
 Form: ☒ generally symmetric ☐ minor asymmetry ☐ major asymmetry ☐ stump sprout ☐ stag-headed
 Crown Class: ☒ dominant ☐ dominant ☐ intermediate ☐ suppressed
 Live crown ratio: _____ % Age Class: ☐ young ☒ semi-mature ☐ mature ☐ over-mature/senescent
 Pruning History: ☐ crown cleaned ☐ excessively thinned ☐ topped ☒ crown raised ☐ pollarded ☐ crown reduced ☐ flush cuts ☐ cabled/braced
☐ none ☐ multiple pruning events Approx. dates: _____
 Special Value: ☐ specimen ☐ heritage/historic ☐ wildlife ☐ unusual ☐ street tree ☐ screen ☐ shade ☐ indigenous ☐ protected by gov. agency

TREE HEALTH

Foliage Cover: ☐ normal ☒ chronic ☐ necrotic Epicormics? ☐ Y ☒ N
 Foliage Density: ☐ normal ☒ sparse Leaf size: ☐ normal ☐ small
 Annual shoot growth: ☐ excellent ☐ average ☒ poor Twig Dieback? ☐ Y ☒ N
 Woundwood development: ☐ excellent ☒ average ☐ poor ☐ none
 Vigor class: ☐ excellent ☒ average ☐ fair ☐ poor
 Major pests/diseases: FUNGAL GROWTH MAIN STEM

SITE CONDITIONS

Site Character: ☒ residence ☐ commercial ☐ industrial ☐ park ☐ open space ☐ natural ☐ woodland/forest
 Landscape type: ☐ parkway ☐ raised bed ☐ container ☐ mound ☐ lawn ☒ shrub border ☐ wind break
 Irrigation: ☒ none ☐ adequate ☐ inadequate ☐ excessive ☐ trunk wetted
 Recent site disturbance? ☒ Y ☐ N ☐ construction ☐ soil disturbance ☐ grade change ☐ line clearing ☐ site clearing
 % dripline paved: 0% 10-25% 25-50% 50-75% 75-100% Pavement lifted? ☐ Y ☒ N
 % dripline w/ill soil: 0% 10-25% 25-50% 50-75% 75-100%
 % dripline grade lowered: 0% 10-25% 25-50% 50-75% 75-100%
 Soil problems: ☒ drainage ☐ shallow ☐ compacted ☐ droughty ☐ saline ☐ alkaline ☐ acidic ☐ small volume ☐ disease center ☐ history of fail
☐ clay ☐ expansive ☐ slope _____? aspect: _____
 Obstructions: ☐ lights ☐ signage ☐ line-of-site ☐ view ☐ overhead lines ☐ underground utilities ☐ traffic ☐ adjacent veg. ☐ _____
 Exposure to wind: ☐ single tree ☒ below canopy ☐ above canopy ☐ recently exposed ☐ windward, canopy edge ☐ area prone to windthrow
 Prevailing wind direction: _____ Occurrence of snow/ice storms ☐ never ☐ seldom ☐ regularly

TARGET

Use Under Tree: ☒ building ☒ parking ☒ traffic ☒ pedestrian ☐ recreation ☐ landscape ☐ hardscape ☐ small features ☐ utility lines
 Can target be moved? ☒ Y ☐ N Can use be restricted? ☒ Y ☐ N
 Occupancy: ☐ occasional use ☐ intermittent use ☒ frequent use ☐ constant use

TREE DEFECTS

ROOT DEFECTS:
 Suspect root rot: ☒ Y ☐ N Mushroom/conk/bracket present: ☒ Y ☐ N ID: _____
 Exposed roots: ☐ severe ☐ moderate ☐ low Underscored: ☐ severe ☐ moderate ☐ low
 Root pruned: _____ Root area affected: _____ % Buttress wounded: ☐ Y ☐ N When: _____
 Restricted root area: ☐ severe ☐ moderate ☐ low Potential for root failure: ☐ severe ☐ moderate ☐ low
 LEAN: < 5 deg. From vertical ☒ Natural ☐ unnatural ☐ self-corrected Soil heaving: ☐ Y ☐ N
 Decay in plane of lean: ☐ Y ☐ N Roots broken: ☐ Y ☐ N Soil cracking: ☐ Y ☐ N
 Compounding factors: _____ Lean severity: ☐ severe ☐ moderate ☐ low

CROWN DEFECTS: Indicate presence of individual defects and rate their severity (s=severe, m=moderate, l=low)

DEFECT	ROOT CROWN	TRUNK	SCAFFOLDS	BRANCHES
Poor taper				
Bow, sweep				
Codominants/forks				
Multiple attachments				
Included bark				
Excessive end weight				
Cracks/splits				
Hangers				
Girdling				
Wounds/seam				
Decay		✓ M		
Cavity				
Conks/mushrooms/bracket				
Bleeding/sap flow		✓ S		
Loose/cracked bark				
Nesting hold/bee hive				
Deadwood/stubs				
Borers/termites/ants				
Cankers/galls/burls				
Previous failure				

HAZARD RATING

Tree part most likely to fall: ENTIRE TREE
 Inspection period: _____ annual _____ biannual _____ other _____
 Failure Potential + Size of Part + Target Rating = Hazard Rating
2 + 3 + 3 = 8

Failure potential: 1-low; 2-medium; 3-high; 4-severe
 Size of part: 1 - <6" (15 cm); 2 - 6-18" (15-45 cm);
 3 - 18-30" (45-75 cm); 4 - > 30" (75 cm)
 Target rating: 1 - occasional use; 2 - intermittent use;
 3 - frequent use; 4 - constant use

HAZARD ABATEMENT

Prune: ☐ remove defective part ☐ reduce end weight ☐ crown clean ☐ thin ☐ raise canopy ☐ crown reduce ☐ restructure ☐ shape
 Cable/Brace: _____ Inspect further: ☐ root crown ☐ decay ☐ aerial ☐ monitor
 Remove tree: ☒ Y ☐ N Replace? ☒ Y ☐ N Move Target: ☐ Y ☐ N Other: _____
 Effect on adjacent trees: ☒ none ☐ evaluate
 Notification: ☒ owner ☐ manager ☐ governing agency Date: 11-14-2022

COMMENTS

1- EXTENSIVE PITCHING PRESENT ON 60% MAIN STEM
 2- SPARSE CANOPY FOLIAGE
 REMOVAL RECOMMENDED

Balden Arboriculture Services
41500 Anderson Road
Nehalem, OR 97131
503-801-3762

TREE LOCATION SITE DIAGRAM

Client: AVILLA
131 HILLS LANE
Date: CANNON BEACH
11-2-2022
Project: TREE EVALUATION

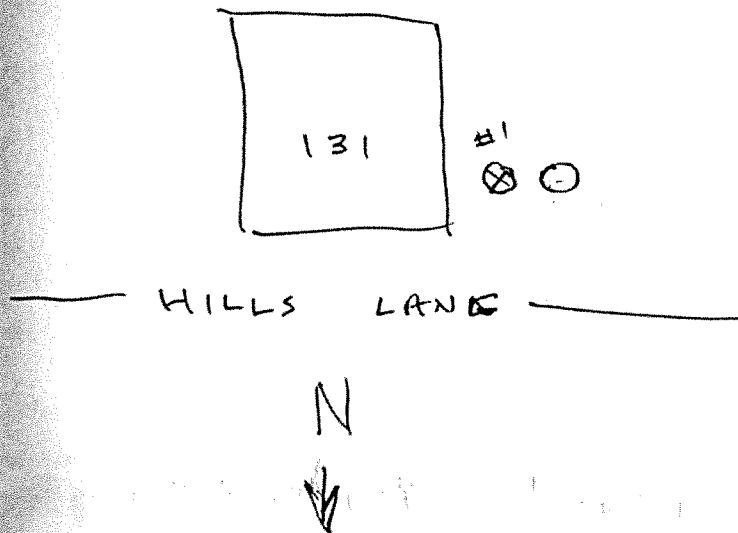

LEGEND

Tree # 1

Species SITKA SPRUCE

Size (DBH) 28

Recommendations REMOVE PER EVALUATION

Sketch not to scale



Treescaping Northwest
Jeff Gerhardt, Consulting Arborist
ISA Certified Arborist #PN-5541A



City of Cannon Beach, Planning Department

Attn: Robert St. Clair
stclair@ci.cannon-beach.or.us
(503) 436-8041

February 8, 2023

Tree Removal Permit Application Review - 131 Hills Lane

Per your request, I reviewed the Tree Removal Permit Application submitted by Sophi Avila. An ISA Tree Hazard Evaluation Form for 1 tree and a site map, was included in the application from Certified Arborist Joe Balden. I visually inspected the tree and site on February 7th. It is my recommendation the removal request for 1 tree be granted.

The tree is a Sitka spruce (*Picea sitchensis*), and is approximately 28" in DBH and 110' tall (photograph attached). The tree exhibits extreme sap dripping from the stem. The living canopy of this tree is minimal relative to the trees size. The tree will likely die soon and I recommend the removal request for this tree be granted according to permit Criteria C, "*The tree presents a safety hazard*".

Best regards,

A handwritten signature in black ink, appearing to read "J Gerhardt", on a light pink rectangular background.

Jeff Gerhardt

Treescaping Northwest
P.O. Box 52
Manzanita, OR 97130

CCB# 236534
Cell: 503-453-5571
www.treescapingnorthwest.com

Declining Sitka spruce @ 131 Hills Lane



Treescaping Northwest
P.O. Box 52
Manzanita, OR 97130

CCB# 236534
Cell: 503-453-5571
www.treescapingnorthwest.com