



Arborist pre-construction report

Client: Jeff Taylor
Site: 1956 S Hemlock, Cannon Beach, OR
Tax/map: 51030DD04300
Contact: 918-261-9705 jeftayok@yahoo.com
Date: 5-19-2023

The project at this site is to deconstruct and replace the existing house with a new three-story house. The current house's footprint will be shifted south and extended west with an addition of a driveway. The driveway will be dug below grade estimated 5-feet to meet up with the projected garage. There are three trees of note to be preserved on the property. These Sitka spruces are labeled A,B and C on the attached site map, and their corresponding critical root zones (CRZ) are shown on the site map. The CRZ is as small as feasible and represents a direct correlation with the trees' drip lines. The driveway should be placed outside the dripline if possible. If more room on the south side of tree A could be allocated to the tree it will be better for the tree. There was some talk of the house moving farther west. I advise against this to preserve tree C. Further movement of the house would mean grading and excavating in the CRZ and the tree will not tolerate that much encroachment, including canopy loss. During construction TPZ barriers should be in place to prevent movement of persons, equipment, or storage of material near the trees (TPZ barriers shown on site plan). The house plan as it exists seems prudent to preserve the mature trees on the property.

Austin Wienecke

ISA Board Certified Master Arborist PN-5890B
Certified Tree Climber Trainer USFS
ISA Tree Risk Assessment trained
General Manager: Arbor Care Tree Specialists Inc.
503-791-0853 austin@arborcarenw.com



A handwritten signature in blue ink that reads "Austin Wienecke".



Site map

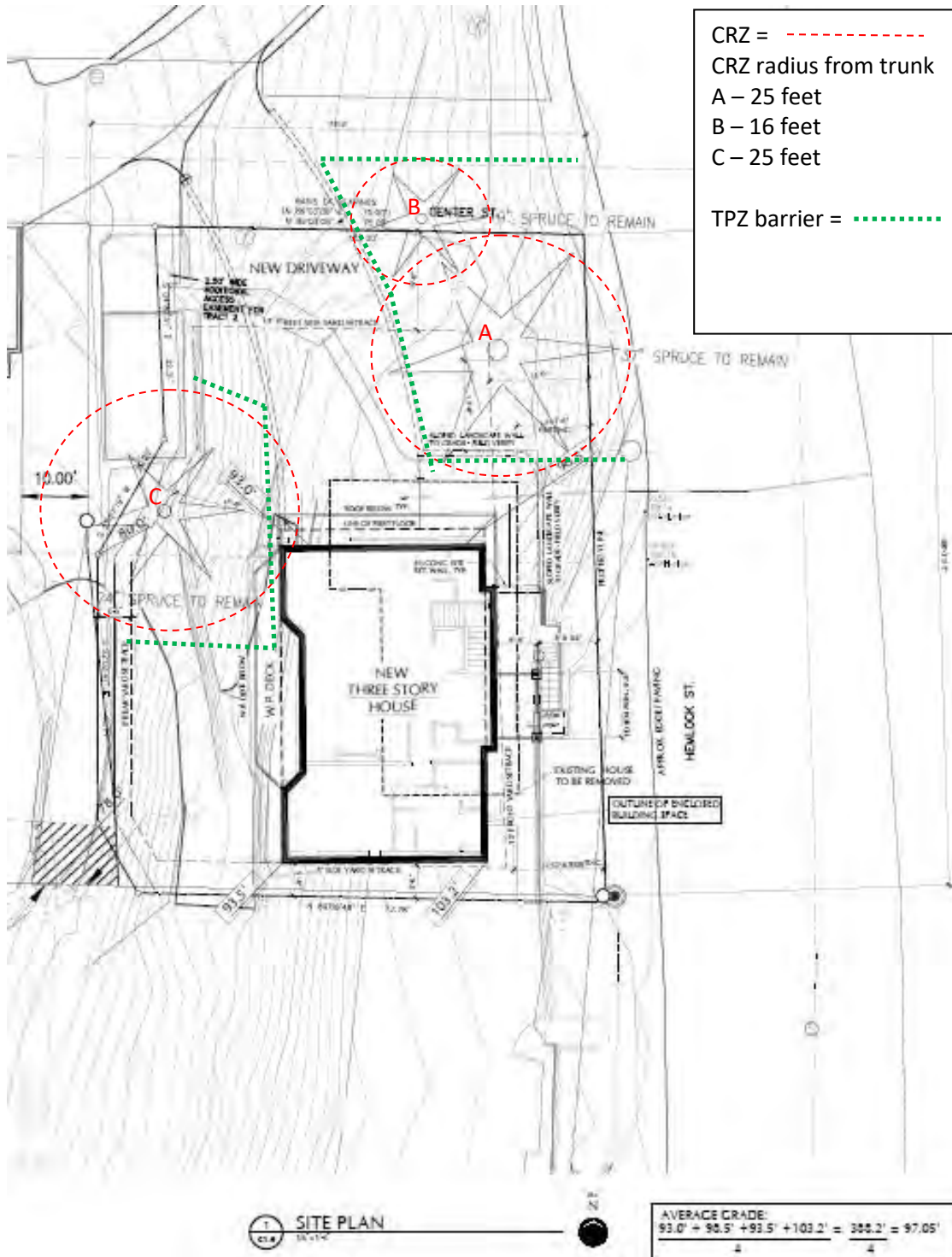



Tree C: note the corner marker of this site plan is already at the tree's dripline/CRZ

