



CANNON BEACH COMMUNITY DEVELOPMENT

163 E. GOWER ST.

PO Box 368

CANNON BEACH, OR 97110

MEMORANDUM

RE: Tree Removal Permit

232 E. Van Buren St., Taxlot 51029BC05001

February 28, 2024

A tree removal permit authorizing the removal of trees that have been identified as hazardous. The trees authorized for removal by this permit are:

- One approximately 26 inch DBH birch (*Betula* sp.)

The application was submitted with a Tree Hazard Evaluation Form prepared by an ISA Certified Arborist as required by CBMC 17.70.030. The application and subject trees have been reviewed by an independent arborist on contract with the City and approval of the application has been recommended.

This removal application meets the criteria of CMBC 17.70.020(A) Permit Issuance - Criteria which states:

A. Removal of a tree which poses a safety hazard. The applicant must demonstrate that:

- 1. The condition or location of the tree presents either a foreseeable danger to public safety, or a foreseeable danger of property damage to an existing structure; and*
- 2. Such hazard or danger cannot reasonably be alleviated by pruning or treatment of the tree.*

Replacement of the removed tree is required as per CBMC 17.70.040(B)(2) Tree Replacement Policy which states:

The basic standard is that four trees should be maintained on a five thousand square foot lot. For larger lots the standard will be applied on a proportional basis, e.g., a seven thousand five hundred square foot lot would require maintenance of six trees. This standard is to be implemented as follows:

2. Tree removal not in conjunction with construction:

- a. If after tree removal the site maintains the standard of at least four trees per five thousand square feet, no replacement is required.*
- b. If after tree removal the site maintains the standard of at least four trees per five thousand square feet, the replanting of trees on a one-for-one basis may be required.*
- c. A minimum density of less than four trees per five thousand square feet may be permitted where it is found that the remaining trees provide sufficient cover, immature trees (those less than six inches diameter) will mature to provide adequate cover, or there are no reasonable locations for new trees.*

Approved trees to be used for replanting are:

- Sitka spruce
- Western hemlock
- Douglas fir
- Western red cedar
- Red alder
- Mountain ash
- Big leaf maple
- Vine maple

This permit may be appealed to the Planning Commission by filing an appeal with the City Manager within 14 days of the date of this decision.

Sincerely,

A handwritten signature in black ink, appearing to be 'R. St. Clair', written in a cursive style.

Robert St. Clair
Planner

City of Cannon Beach Tree Removal Application **FEB 13 2024**

Please fill out this form completely. Please type or print.

Received

Applicant Name: MARK ARTHUR AND NORA CURTIS

Mailing Address: 14839 SW PENINSULA DR TERREBONNE, OR 97760

Phone: 503-858-7168 (MARK) 503-720-4267 (NORA) Email: mark.r.arthur@icloud.com

Property Owner Name: SAME AS ABOVE

Mailing Address: _____

Phone: _____ Email: _____

Property Location: 232 E. VAN BUREN Map/Tax Lot Number: 51029 BC 05001

The city shall issue a tree removal permit if one of the following criteria is met. Please circle the letter of the criteria that applies.

These criteria require a Tree Removal Report from an International Society of Arboriculture (ISA) Certified Arborist:

- A. You are constructing a structure or development approved and allowed by pursuant to Cannon Beach Municipal Code 17.70.030, which involves any form of ground disturbance; including required vehicular and utility access. **SEE ATTACHMENT A – Removing Trees Because of Construction.**
- B. Removal of a tree for the health and vigor of surrounding trees.

These criteria require an ISA Tree Hazard Evaluation Form prepared by an ISA Certified Arborist:

- ☒ C. The tree presents a safety hazard, where:
 - 1. The condition or location of the tree presents either a foreseeable danger to public safety, or a foreseeable danger of property damage to an existing structure; and,
 - 2. Such hazard or danger cannot reasonably be alleviated by pruning or treatment of the tree.
- D. The tree was damaged by storm, fire or other injury, which cannot be saved by pruning.

You must submit a tree removal permit with a reason if:

- E. The tree is dead.
- F. Tree removal is necessary to provide solar access to a solar energy system where pruning will not provide adequate solar access:
 - 1. The city may require documentation that a device qualifies for Oregon Department of Energy Solar Tax Credit, or other incentive for installation of solar devices offered by a utility.
 - 2. No tree measuring more than 24 inches in diameter shall be removed for solar access.
- G. Tree removal is for landscaping purposes, subject to the following conditions:
 - 1. The tree cannot exceed 10 inches in diameter.
 - 2. A landscape plan for the affected area must be submitted and approved by the City.
 - 3. The landscape plan must incorporate replacement trees for the trees removed. The replacement trees must be at least six feet in height or have a two-inch caliper; and,
 - 4. The City shall inspect the property one year after the approval of the permit to insure the landscape plan has been implemented.

If your tree presents an immediate danger of collapse and if such potential collapse represents a clear and present hazard to persons or property, please contact the Community Development Director (CDD). If it is determined by the CDD that there is an immediate danger, then a tree removal permit is not required prior to tree removal. However, within seven days after the tree removal, the tree owner shall make application for an after-the-fact permit. Where a tree presents an immediate danger of collapse, a complete ISA Tree Hazard Evaluation Form prepared by a certified arborist is not required. Where a safety hazard exists, as defined by this subsection, the city may require the tree's removal. If the tree has not been removed after forty-eight hours, the city may remove the tree and charge the costs to the owner.

FEB 13 2024

PAID

Attach a site plan showing the location and type of all trees on the property, including the trees to be removed. Indicate the location of replacement trees and the type. SEE ATTACHMENT B – Site Plan. Attach photos of the trees to be removed and mark the trees with ribbon.

Explain how the request meets one or more of the applicable criteria. Include the number and type of trees requested for removal. If appropriate, explain why pruning would not accomplish the same goal as tree removal.

THIS ~70 Y.O. BIRCH HAS HAD MULTIPLE LARGE SCAFFOLD BRANCH FAILURES OVER THE PAST SEVERAL YEARS, RESULTING IN MULTIPLE DEEP WOUNDS IN THE TRUNK. IT NOW HAS CONKS AND DECAY AT 4" DEEP. THE MOST RECENT FAILURE WAS IN JANUARY 2024 RESULTING IN DAMAGE TO ROOF + GUTTER. LARGE BRANCHES AT RISK ARE ABOVE 232+216 E. VAN BUREN. TREE WAS "WINDOW PANELED" APPROXIMATELY 15 YRS AGO. FURTHER PRUNING NOT AN OPTION, AS THERE ISN'T ANYTHING HELPFUL LEFT TO PRUNE. ROOTS ON W. SIDE WERE CUT BY CONSTRUCTION OF 216 E. VAN BUREN. TREE IS UNSTABLE. SEE TREE HAZARD EVALUATION FORM COMPLETED BY BALDEN ARBORICULTURE (ISA# PNOT36) FEBRUARY 2024 FOR FURTHER INFORMATION.

TREE IS MARKED WITH ORANGE PAINT.

Application fee: \$50.00 for 1-4 trees; \$100 for 5 or more trees

Note: The application fee is a **nonrefundable** fee that is due upon receipt of application, whether the removal request is approved or denied.

Applicant Signature _____ Date: _____

If the applicant is other than the owner, the owner hereby grants permission for the applicant to act in their behalf.

Property Owner Signature: *Mc* Date: 2/9/2024

Please attach the name, address, phone number and signature of any additional property owners.

I understand, as property owner, that I am responsible if an approved tree removal permit is violated in any way. As property owner, my signature or an authorized applicant's signature, allows any duly authorized employee of the City to enter upon all properties affected by this permit, for the purpose of follow-up inspection, observation or measurement.

Date: _____ Fee Paid: \$ _____ Receipt Number: _____ Permit #: _____
City of Cannon Beach
Finance Department

Application is:

☒ Approved ☐ Denied
☒ Approved - Tree replacement required per Cannon Beach Municipal Code 17.70.040, Tree Replacement Policy.
☐ Approved with comments:

By: *Robert St. Clair* Robert St. Clair, Planner Date: February 28, 2024

Decisions on the issuance of a tree removal permit may be appealed to the Planning Commission in accordance with Section 17.88.140 a, of the Municipal Code.

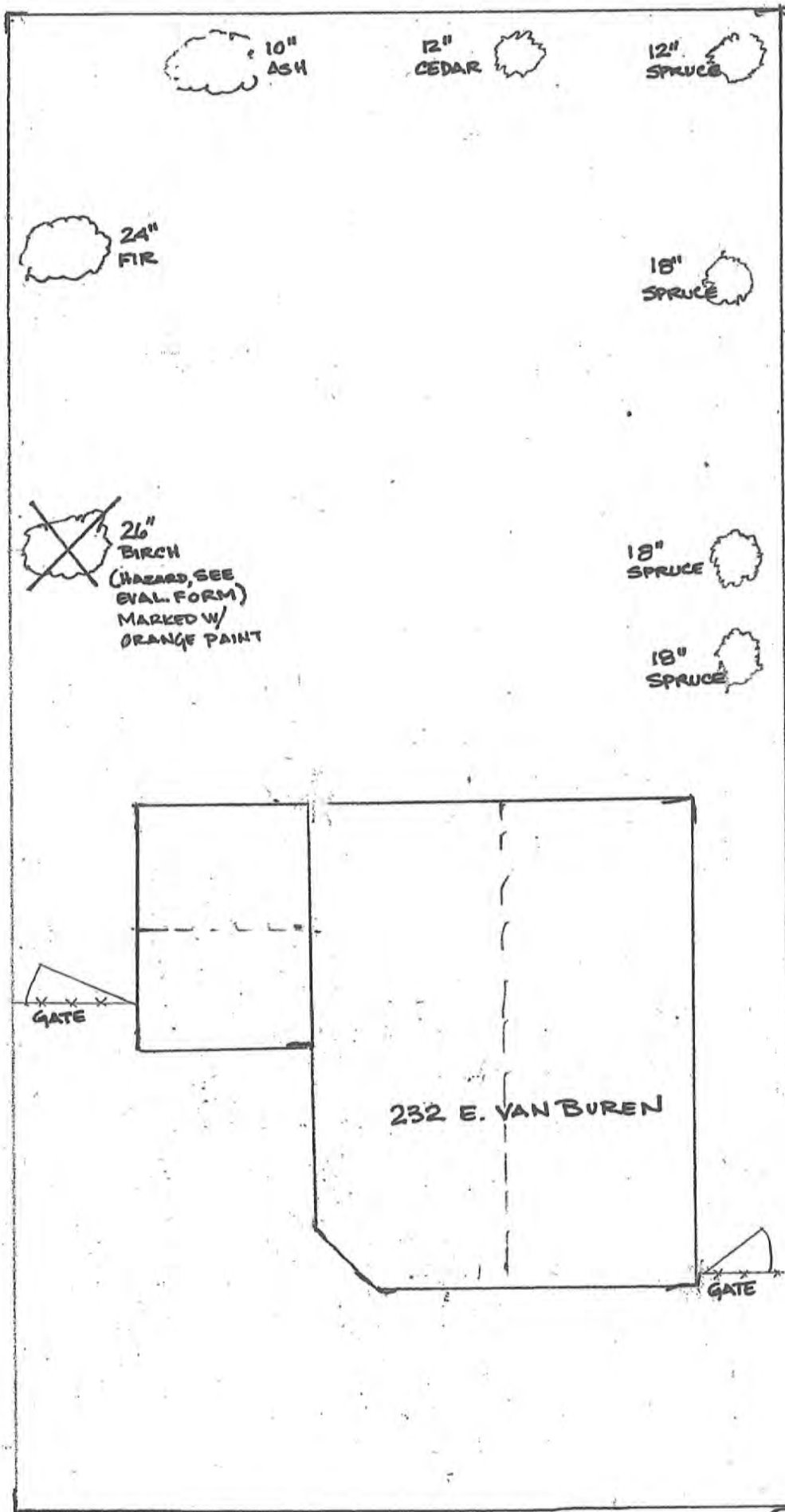

City of Cannon Beach
Finance Department

FEB 13 2024

PAID



A Photographic Guide to the Evaluation of Hazard Trees in Urban Areas
TREE HAZARD EVALUATION FORM 2nd Edition

Site/Address: 232 E. VAN BUREN

Map/Location: _____

Owner: public _____ private ☒ unknown _____ other _____

Date: 2-6-24 Arborist: BALDEN ISA# 190736

Arborist's Signature: [Signature]

HAZARD RATING:

2 + 3 + 3 = 8
Failure Potential + Size of part + Target = Hazard Rating
8 Immediate action needed
Needs further inspection
Dead tree

TREE CHARACTERISTICS

Tree #: 1 Species: BETULA SP. (BIRCH)

DBH: 26 # of trunks: 1 Height: 40 Spread: 30

Form: ☒ generally symmetric ☐ minor asymmetry ☐ major asymmetry ☐ stump sprout ☐ stag-headed

Crown Class: ☐ dominant ☐ co-dominant ☒ intermediate ☐ suppressed

Live crown ratio: 60% Age Class: ☐ young ☐ semi-mature ☒ mature ☐ over-mature/senescent

Pruning History: ☐ crown cleaned ☐ excessively thinned ☐ topped ☐ crown raised ☐ pollarded ☐ crown reduced ☐ flush cuts ☐ cabled/braced

☐ none ☒ multiple pruning events Approx. dates: ✓

Special Value: ☐ specimen ☐ heritage/historic ☐ wildlife ☐ unusual ☐ street tree ☐ screen ☐ shade ☐ indigenous ☐ protected by gov. agency

TREE HEALTH

Foliage Cover: ☐ normal ☐ chronic ☐ necrotic Epicormics? Y N

Foliage Density: ☐ normal ☐ sparse Leaf size: ☐ normal ☐ small

Annual shoot growth: ☐ excellent ☐ average ☐ poor Twig Dieback? Y N

Woundwood development: ☐ excellent ☐ average ☒ poor ☐ none

Vigor class: ☐ excellent ☒ average ☐ fair ☐ poor

Major pests/diseases: _____

Growth obstructions:

☐ stakes ☐ wire/fies ☐ signs ☐ cables

☐ curb/pavement ☐ guards

☐ other _____

SITE CONDITIONS

Site Character: ☒ residence ☐ commercial ☐ industrial ☐ park ☐ open space ☐ natural ☐ woodland/forest

Landscape type: ☐ parkway ☐ raised bed ☐ container ☐ mound ☒ lawn ☐ shrub border ☐ wind break

Irrigation: ☒ none ☐ adequate ☐ inadequate ☐ excessive ☐ trunk wetted

Recent site disturbance? Y ☒ N ☐ construction ☐ soil disturbance ☐ grade change ☐ line clearing ☐ site clearing

% dripline paved: 0% 10-25% 25-50% 50-75% 75-100% Pavement lifted? Y N

% dripline w/fill soil: 0% 10-25% 25-50% 50-75% 75-100%

% dripline grade lowered: 0% 0-25% 25-50% 50-75% 75-100%

Soil problems: ☐ drainage ☐ shallow ☐ compacted ☐ droughty ☐ saline ☐ alkaline ☐ acidic ☐ small volume ☐ disease center ☐ history of fail

☐ clay ☐ expensive ☐ slope _____? aspect: _____

Obstructions: ☐ lights ☐ signage ☐ line-of-site ☐ view ☐ overhead lines ☐ underground utilities ☐ traffic ☐ adjacent veg. ☐ _____

Exposure to wind: ☐ single tree ☒ below canopy ☐ above canopy ☐ recently exposed ☐ windward, canopy edge ☐ area prone to windthrow

Prevailing wind direction: _____ Occurrence of snow/ice storms: ☐ never ☐ seldom ☐ regularly

TARGET

Use Under Tree: ☒ building ☐ parking ☐ traffic ☐ pedestrian ☐ recreation ☐ landscape ☐ hardscape ☐ small features ☐ utility lines

Can target be moved? Y ☒ N ☐ Can use be restricted? Y N

Occupancy: ☐ occasional use ☒ intermittent use ☐ frequent use ☐ constant use

TREE DEFECTS

ROOT DEFECTS:

Suspect root rot: ☒ Y ☐ N Mushroom/conk/bracket present: ☒ Y ☐ N ID: _____
 Exposed roots: ☐ severe ☐ moderate ☐ low Undamaged: ☐ severe ☐ moderate ☐ low
 Root pruned: W. side Root area affected: 30 % Buttress wounded: Y ☒ N When: _____
 Restricted root area: ☐ severe ☐ moderate ☐ low Potential for root failure: ☐ severe ☐ moderate ☐ low
 LEAN: < 5 deg. From vertical ☒ natural ☐ unnatural ☐ self-corrected Soil heaving: Y ☐ N
 Decay in plane of lean: Y ☐ N Roots broken: Y ☐ N Soil cracking: Y ☐ N
 Compounding factors: _____ Lean severity: ☐ severe ☐ moderate ☐ low

CROWN DEFECTS: Indicate presence of individual defects and rate their severity (s=severe, m=moderate, l=low)

DEFECT	ROOT CROWN	TRUNK	SCAFFOLDS	BRANCHES
Poor taper				
Bow, sweep				
Codominants/orks				
Multiple attachments				
Included bark				
Excessive end weight			✓	M
Cracks/splits				
Hangers				
Girdling				
Wounds/scar		✓	S	
Decay		✓	S	
Cavity				
Conks/mushrooms/bracket		L	M	
Bleeding/sap flow				
Loose/cracked bark				
Nesting hole/bee hive				
Deadwood/stubs		✓	M	
Borers/termites/ants				
Cankers/galls/burls			✓	S
Previous failure				

HAZARD RATING

Tree part most likely to fall: ENTIRE TREE
 Inspection period: _____ annual _____ biannual _____ other _____
 Failure Potential + Size of Part + Target Rating = Hazard Rating
2 + 2 + 3 = 7

Failure potential: 1-low; 2-medium; 3-high; 4-severe.
 Size of part: 1 - <6" (15 cm); 2 - 6-18" (15-45 cm);
 3 - 18-30" (45-75 cm); 4 - > 30" (75 cm)
 Target rating: 1 - occasional use; 2 - intermittent use;
 3 - frequent use; 4 - constant use

HAZARD ABATEMENT

Prune: ☐ remove defective part ☐ reduce end weight ☐ crown clear ☐ thin ☐ raise canopy ☐ crown reduce ☐ restructure ☐ shape
 Cable/Brace: _____ Inspect further: ☐ root crown ☐ decay ☐ aerial ☐ monitor
 Remove tree: ☒ Y ☐ N Replace? Y ☒ N Move Target: Y ☒ N Other: _____
 Effect on adjacent trees: ☒ none ☐ evaluate
 Notification: ☒ owner ☐ manager ☐ governing agency Date: 2-6-24

COMMENTS

1- MULTIPLE SCAFFOLD BRANCH FAILURES. CAVITY IN MAIN STEM.
 2- CONKS ON NORTH SIDE MAIN STEM.
 3- DRILLED FOR DEPTH OF SOUND WOOD. DECAY AT 4"
 REMOVAL RECOMMENDED 



Treescaples Northwest
Jeff Gerhardt, Consulting Arborist
ISA Certified Arborist #PN-5541A



City of Cannon Beach, Planning Department

Attn: Robert St. Clair
stclair@ci.cannon-beach.or.us
(503) 436-8053

February 26, 2024

Tree Removal Permit Application Review - 232 E Van Buren

Per your request, I reviewed the Tree Removal Permit application submitted by Mark Arthur and Nora Curtis. Included in the application is a site map, and an ISA evaluation form from Certified Arborist, Joe Balden. I visually inspected the tree and site on February 26th, and recommend the removal request for one tree be approved.

The tree being requested be removed is a birch (*Betula sp.*). The tree is approximately 26" in diameter and 45'. Joe Balden inspected the tree for internal decay and determined there is an excessive amount. As such, the tree has a high risk of failure and is in close proximity to multiple residences. I recommend the tree be given approval for removal based on Permit Criteria C: "*The tree presents a safety hazard...*". Due to the advanced internal decay in the main stem, the tree is not a good candidate for preservation pruning.

I recommend a suitable replacement tree be planted in the backyard.

Best regards,

A handwritten signature in black ink, appearing to read "Jeff Gerhardt".

Jeff Gerhardt

Treescaples Northwest
P.O. Box 52
Manzanita, OR 97130

CCB# 236534
Cell: 503-453-5571
www.treescaplesnorthwest.com

Birch tree in the backyard @ 232 E Van Buren



Treescapen Northwest
P.O. Box 52
Manzanita, OR 97130

CCB# 236534
Cell: 503-453-5571
www.treescapenorthwest.com